

## Confirmed Exhibitors at IPUM 2008

- 3D Scan IT
- AICON 3D Systems
- Creaform
- Hexagon Metrology
- Konica Minolta
- Multi Metrics
- NDI and Perceptron
- ShapeGrabber
- Steinbichler



## IPUM 2008 Macro Contest

InnovMetric is pleased to announce that it will hold the first edition of its PolyWorks Macro Contest at the IPUM 2008. The competition is open to all users of PolyWorks worldwide. A jury will select 5 macros to be presented at the IPUM banquet dinner. The winner will be voted by the audience.

To enter the contest, you need to prepare a 2-minute video showing the PolyWorks macro in action, along with a short text description of the application for which the macro was developed.

If you are interested in participating, simply contact [Sacha Villeneuve](mailto:Sacha.Villeneuve@innovmetric.com) before May 1, 2008.



## New PolyWorks Distributors

**Dimensional Engineering**  
Territory: USA  
Reseller: PolyWorks/Inspector Probing Package  
Contact: [Bill Bonner](mailto:Bill.Bonner@dimeng3d.com)  
[www.dimeng3d.com](http://www.dimeng3d.com)

**Konica Minolta Sensing Europe**  
Territory: Europe  
PolyWorks bundled with: Konica Minolta  
Contact: [Tsutomu Ogasawara](mailto:Tsutomu.Ogasawara@konicaminolta-isd.com)  
[www.konicaminolta-isd.com](http://www.konicaminolta-isd.com)

**Hexagon Metrology Makine Ticaret ve Sanayi Ltd.Sti.**  
Territory: Turkey  
PolyWorks bundled with: Leica T-Scan and portable CMMs  
Contact: [Levent Yesilbag](mailto:Levent.Yesilbag@leica-geosystems.com)  
[www.leica-geosystems.com/metrology](http://www.leica-geosystems.com/metrology)

## InnovMetric announces its keynote speakers for IPUM 2008

Preparations for IPUM 2008 are going great, with many PolyWorks users, distributors, and prospects already registered. This event will be a unique opportunity to learn the new features of PolyWorks V11 and to discover the new 3D digitizing technologies with more than 20 manufacturers demonstrating their equipment.

IPUM 2008 will also feature several presentations by PolyWorks users sharing their real-life applications with the audience.

Keynote speakers already confirmed:

- **Dr. Lay Knoerr, General Motors and Dr. Luis Guzman, University of Michigan**  
*Feature-Based GD&T with Modes of Variation*
- **Chris Simmons, Rolls-Royce**  
*Aerofoil Measurement, Past, Present, and Future*
- **Dirk Kissinger, Opel**  
*Use of PolyWorks as Analysis Tool in Central Quality Assurance at General Motors Europe*
- **Angelo Beraldin, NRC-IIT Canada**  
*3D imaging metrology: NRC-IIT dedicated laboratory and work towards a universal standard*

[Click here to download the Official Invitation for IPUM2008](#)

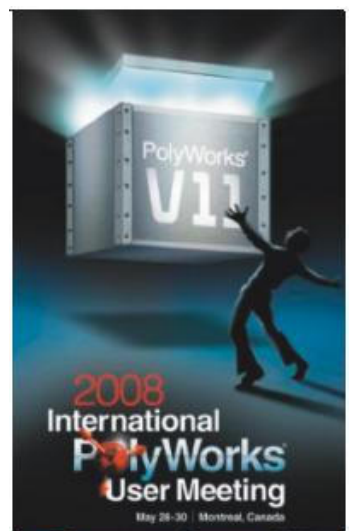

## Register now and save 20% on the registration fee



**International PolyWorks User Meeting – May 29-30, 2008** (open to users, distributors, service bureaus, partners, prospects, and scanner manufacturers)

- PolyWorks technical and application presentations
- IPUM 3D Digitizer Expo
- Workshops and doctor's office meetings
- Banquet and social activities

**PolyWorks Distributor Meeting – May 28, 2008** (reserved for authorized PolyWorks distributors only)

- Technical presentations, sales strategies, competitive analysis, marketing initiatives, and more
- Distributors dinner and social activities



### Registration Fee

**Before February 29, 2008: C\$200**  
**After February 29, 2008: C\$250**  
(PolyWorks Distributors: No charge)

[Click here to register for IPUM2008](#)

## Tips & Tricks

### Boundary scanning in PolyWorks 10.1

In sheet metal inspection, a common task consists of inspecting the trimmed edges of a part, whether they are the external shape of the part or internal shapes such as circles, slots, polygons, etc.

A new function has been introduced in PolyWorks 10.1 for scanning the trimmed edges of sheet metal parts. This new function can inspect outer as well as inner edges.

PolyWorks extracts, in real-time, the points located on the theoretical sharp edge boundary. Curve-based features such as circles and slots may directly be fitted to these boundary points giving you fast, efficient, and accurate results.

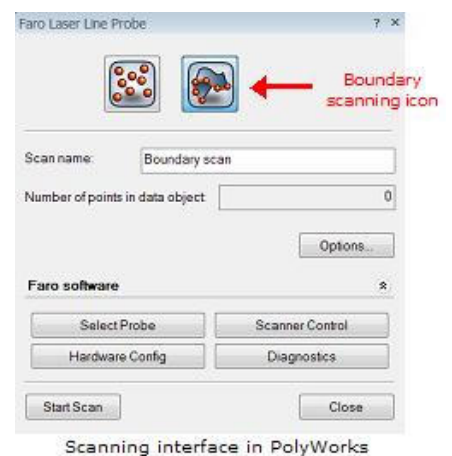

[Download a video demonstration of boundary scanning in PolyWorks 10.1](#)

## New PolyWorks Probing Learning Guide

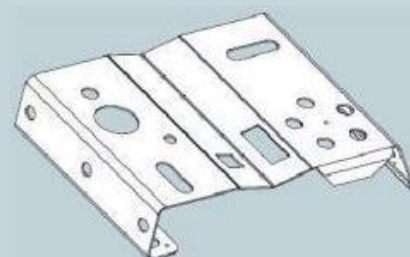

InnovMetric's Application Specialists have prepared an exercise-oriented and video-based guide, designed to help you learn probing basics using the PolyWorks/Inspector Probing™ package.

The sheet metal part and the datasets required to perform these exercises are available on the "Learning Guide CD" included in each PolyWorks box. The exercises and videos are also available from the "Tutorials" section of InnovMetric's Technical Support Zone.



### PolyWorks 10.1 New Features Brochure

With the release of PolyWorks 10.1, InnovMetric has prepared a new brochure that describes some of the new features. This brochure is an excellent tool when promoting the renewal of support/maintenance contracts, as it shows the benefits of upgrading to the latest PolyWorks release.

[Download the PolyWorks 10.1 brochure](#)